

DWG NO.

200-34-10-850A

NOTES:

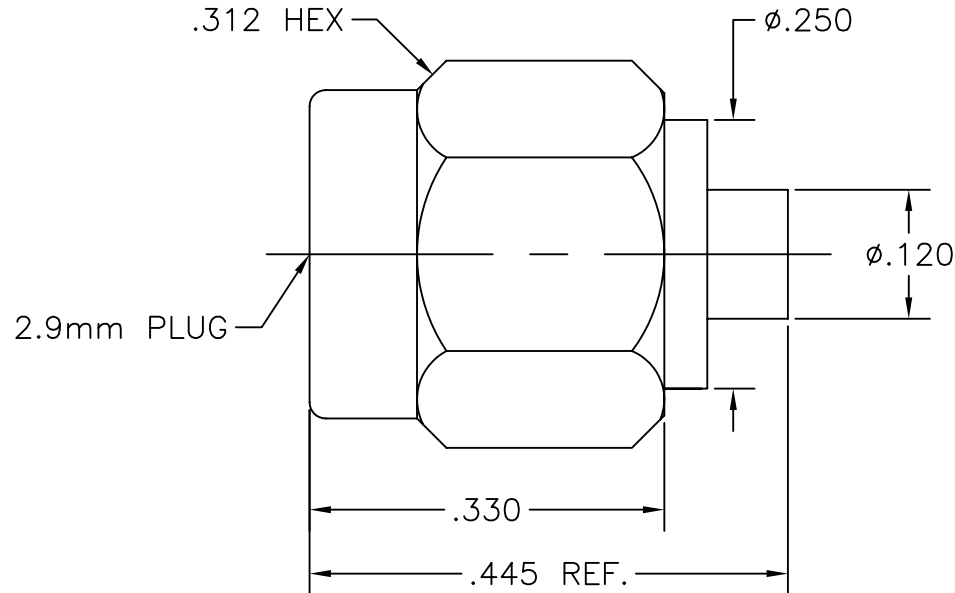

"ASSEMBLED"

DWG NO. <b>200-34-10-850A</b>		<b>SGMC MICROWAVE</b> www.sgmcmicrowave.com		USED ON: <b>"OUTLINE DRAWING"</b>		REVISIONS		
TITLE: <b>2.9mm MALE TO                  .085 SEMI-RIGID                  CABLE (Direct Solder)</b>		SCALE: NTS	CAGE CODE: 1UYM4	SIZE: A	SHEET: 1 OF 1	DRAWN: LRH	APPR:	
"PROPRIETARY INFORMATION" THE INFORMATION WITHIN THIS DRAWING IS PROPRIETARY AND SHALL NOT BE USED OR DISCLOSED WITHOUT PRIOR WRITTEN PERMISSION FROM (SGMC) SGMC MICROWAVE.		UNLESS OTHERWISE SPECIFIED: 1. REMOVE ALL BURRS. 2. ALL DIMENSIONS ARE AFTER PLATING. 3. BREAK ALL CORNERS & EDGES .005 R. MAX. 4. CHAMFER 1st & LAST THREADS 45°. 5. DIAMETERS ON COMMON CENTERS SHALL BE CONCENTRIC WITHIN .002 T.I.R. 6. ALL SURFACES FINISHED TO 32√.		TOLERANCES ALL DIMENSIONS ARE IN INCHES "DECIMALS" .X ±.030 .XX ±.010 .XXX ±.005	FINISH:		MATERIAL:	
						LTR: --	DESCRIPTION: (ECN#) DWG. RELEASED	DATE: 06/15/01